



PORTABLE PRIMARY HEALTH CARE CENTER



Project Overview & Stakeholders



Product: Portable primary Health Van for on-farm veterinary services.



Key Partners: Govt. Livestock dept., NGO's, AI semen suppliers, cold chain vendors



Primary Users: Smallholder farmers, dairy cooperatives, commercial farms. Service delivered by veterinarian + 1-2 Paravets / technicians.



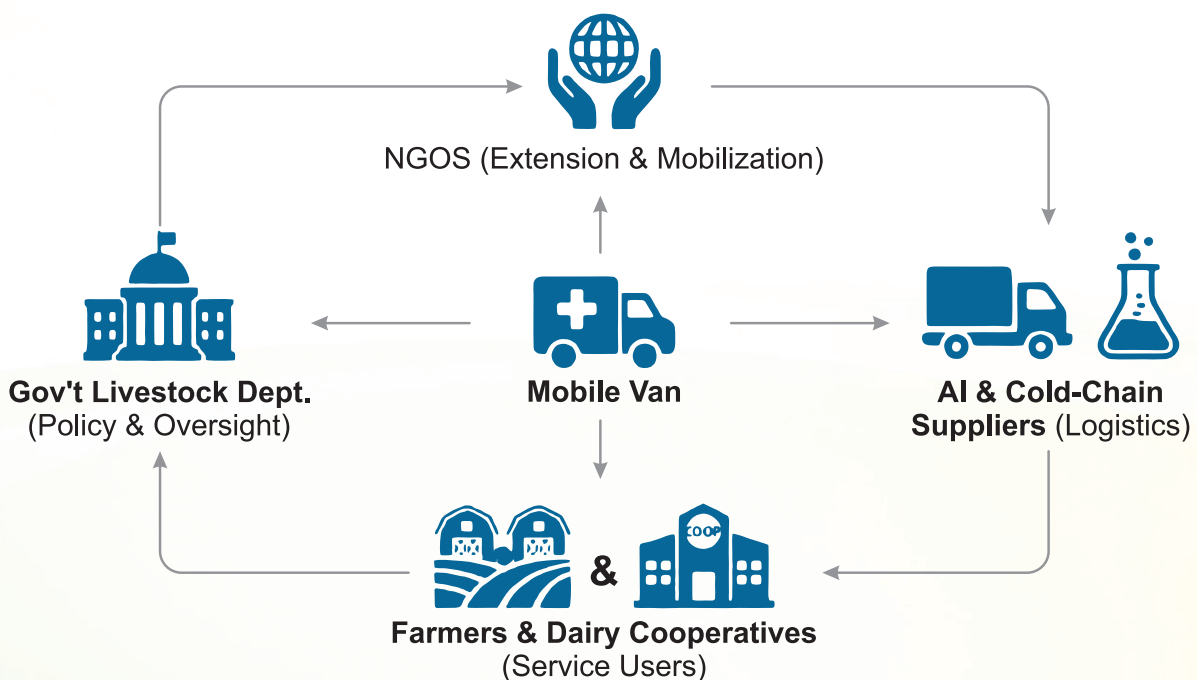

Operational Reach: Rural districts, milk sheds. Mobile range typically 30-100km per day

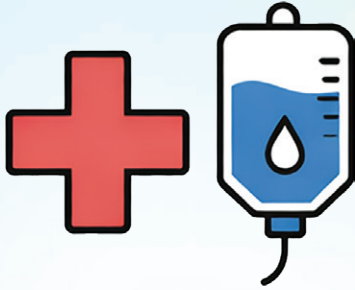

Core Services Provided





EMERGENCY TREATMENT

-  On-site Triage, IV fluids
-  Wound care, Antishock Drugs
-  Minor Stabilization



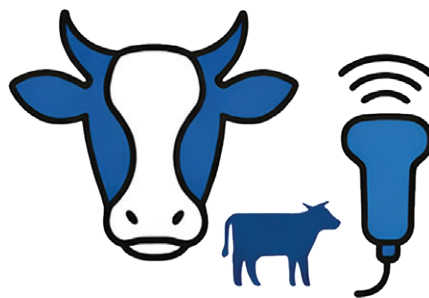

PREVENTIVE CARE

-  Vaccinations for FMD, HS BQ, rabies
-  De-worming & mineral mixtures



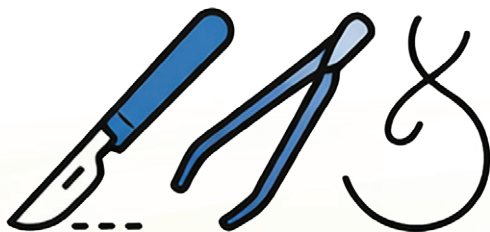

REPRODUCTIVE SERVICES

-  Artificial Insemination (AI)
-  Pregnancy diagnosis via portable ultrasound
-  Calving assistance





MINOR SURGERIES

-  Castration, abscess drainage
-  Emergency caesarean support
-  Rumentology procedures



FARMER AWARENESS

-  On-farm training & posters
-  Pamphlet & AV material in local languages

DHARMA Pallet Core of the Portable PHC



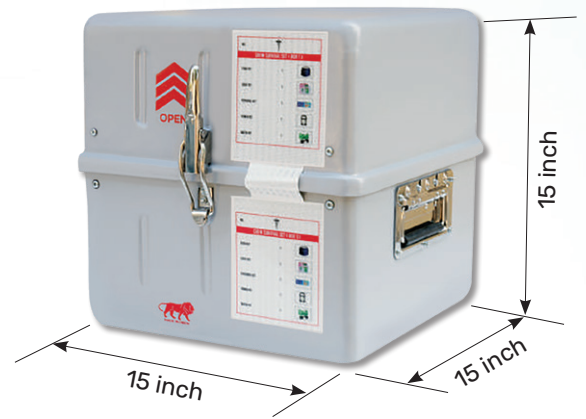

**CARRIES - 27 OR 36
MINI CUBES
TRANSPORTS - UPTO 900 KG
CAN BE WINCHED IN & OUT OF TRUCK**

**EACH CUBE MEASURES
15 X 15 X 15 INCHES.
CAN CARY: UPTO 20KG**



Power Sources

Solar Panel

-  **Extra Power**
-  **Extra Life**
-  **Double-Sided Power Generation**
-  **Excellent anti-LeTID & anti-PID performance**
-  **Lower temperature coefficient**
-  **Lower LCOE & System cost**

- Module Efficiency >22%**
- Power Tolerance up to 4.99W**
- 30 Years Performance Warranty**
- 12 Years Product Warranty**
- PID Resistant**
- Outstanding Aesthetic Design**



Inverter

Model Number/Name	Elithium 3532
Nominal DC Voltage	25.6V
Input Power at Peak Load	2500 Watts
Switching Element	MOSFET
Nominal Battery Voltage	25.6V
Nominal Output Voltage	220V
Nominal Output Frequency	50Hz
Max. Output Nominal Current	9.5 Amps

HEAVY LOADS : Runs your 1.5T inv AC on EL 3532 • Built to withstand overloads up to 200%

PREMIUM DESIGN : Wall mounted sleek design • Minimalist colours to match your decor • No more shoddy battery wiring

LITHIUM ADVANTAGE : Zero battery maintenance • Works well with heavy motor loads • Longer life and more kWh per cycle

PLUG N PLAY : LFP battery, factory-fitted and connected • Easily connect PV, GRID and LOADS • DIY System, needs zero expertise to install



Generator

Model	UI-15i
Max AC. Output VA	1200
Rated AC. Output VA	990
Type OHV25°Inclined, Single Cylinder, 4 Strokes, S.I, Forced Air Cooling	
Maximum Power	3.0 hp @ 3600rpm
Displacement	98cc
Starting System	Recoil Start
Fuel	Petrol
Tank Capacity	Petrol -2 Ltr.
Gross weight-KG	16.7 KG
Dimension LxWxH (mm)	355 X 350 x 380



Internal Sections Side

Electrical Section Product Section Utility Section

- 4 Solar panels
1240mm X 1000mm
X 35mm
- Mounting frame
- Refrigerator
(mini bar)
- Generator
- Inverter & battery
cabinet
- Electric winch

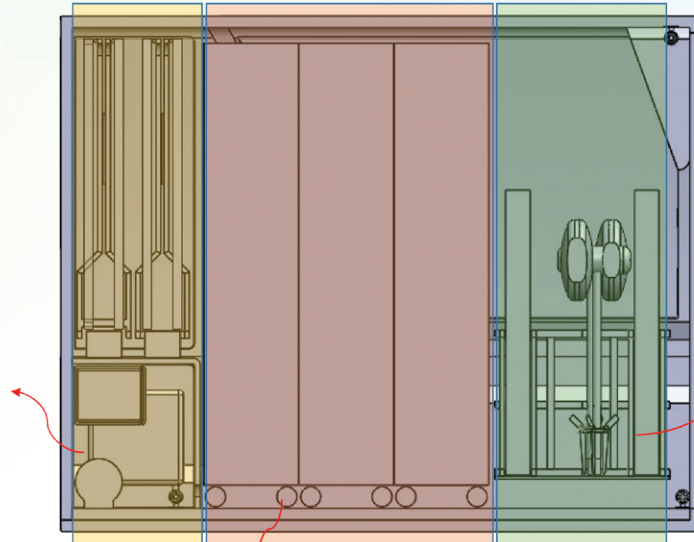

- Aluminium trolley
on wheels
- 4 Pedestal fans
- 4 folding chairs
- 2 Collapsible Tent

- 1 X MS pallet with 27
aluminium boxes

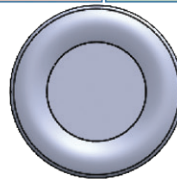

Ramp for Winching Loading & Unloading

All panels open perspective

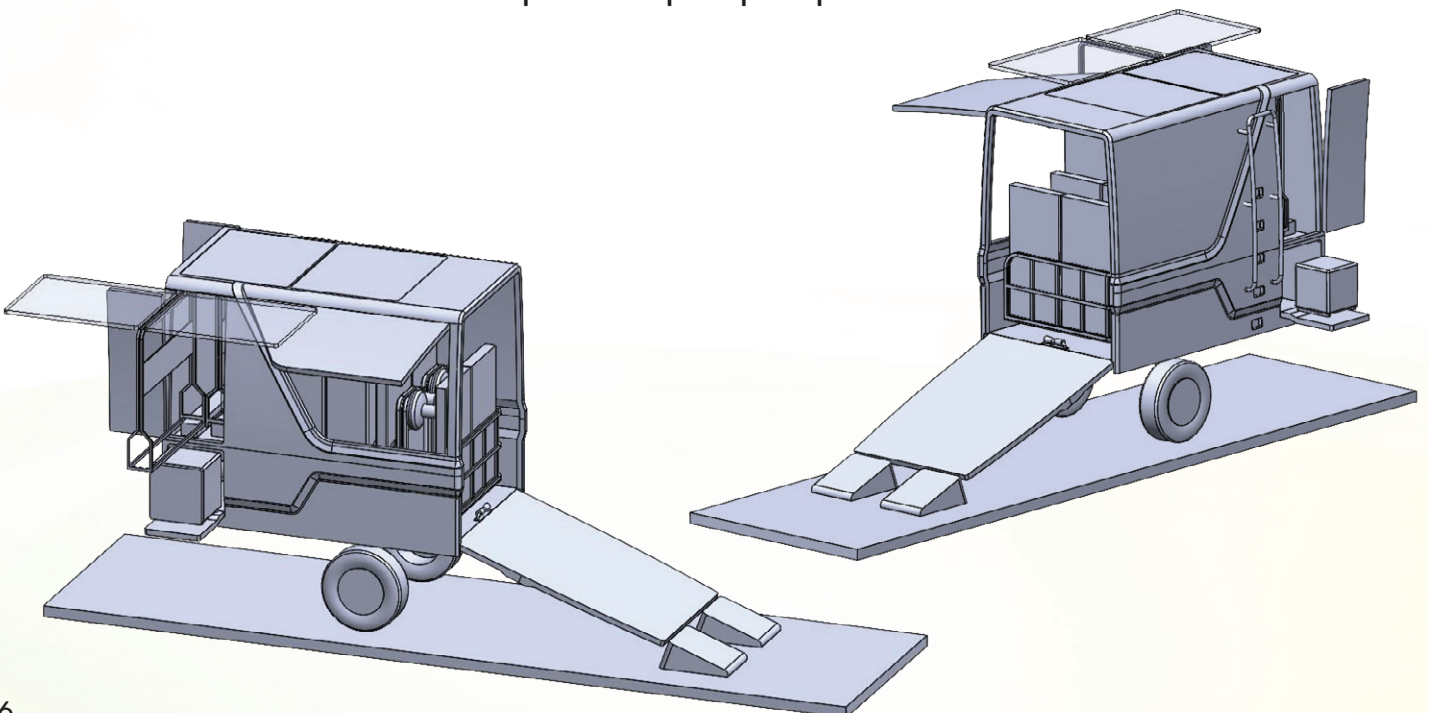

Portable Primary Health Center for Live Stock

An agile, Van-based PHC that brings a fully functional clinic to remote communities. Adapted from India's DHARMA portable hospital concept, it uses compact "mini-cubes" to deliver primary care, diagnostics, minor procedures, emergency stabilization and public-health services at the doorstep in a specially designed Mini-Van.







Advantages of Portable PHC

As it is mobile and it takes only 20-30 minutes to set up, it can have a camp in one village from 9AM to 1PM and in the second village from 2pm to 6pm, therefore covering 2 places. If the same places are covered twice a week, the same Portable PHC can cover 6 villages every week. This leads to :-

- Savings of capital costs of building 6 permanent PHC's v/s only 1 Portable PHC. Thus cost of building + cost of diagnostic equipment is saved.
- Saving of Manpower Only 1 doctor and 1 paramedic can run the center in all these 6 villages. If the number of patients is higher, they will also need 1 Lab technician & 1 radiologist.
- Vaccination camps like polio, immunization or any epidemic can be easily done too.
- If the population of a village is very less, say 3000-4000, it is not commercially viable to set up an independent PHC there. In such cases 1 portable PHC can be sufficient for 3-4 such remote villages.
- As compared to Mobile Medical Vans currently in use for Awareness campaigns, Blood donation, Immunization etc, which are built at 6 times the cost of such a Truck, their capacity to transport so much equipment and consumables is quite less in those medical vans.

Examination & Handling Equipment

- Heavy-duty examination table/ portable Cattle Travis
- Animal restraining ropes & head halters
- Nose tongs
- Hoof trimming tools
- Large-animal weighing tape
- Thermometer & stethoscope (large-animal type)
- Induction & Heating Container
- First aid kit for Doctors & Paravet staff



Diagnostic Equipment

- Portable ultrasound (pregnancy & organ check)
- Mastitis testing kit (CMT)
- Blood collection & testing kits
- Portable microscope
- Glucometer
- Portable X-Ray
- Fetotomykit (For difficult calving)
- Rapid disease test kits (FMD, Brucellosis, HS)

Treatment & Emergency Care

- IV fluid administration sets (large-bore)
- Long needles & syringes
- Catheters (large-animal size)
- Wound suturing & dressing kits
- Anti-shock drugs



Medicines & Vaccines

- Antibiotics (injectable)
 - NSAIDs & pain relievers
 - Deworming medicines
- Vaccines:**
- FMD (Foot & Mouth Disease)
 - HS (Haemorrhagic Septicemia)
 - BQ (Black Quarter)
 - Rabies
 - Mineral mixtures & calcium injections

Reproductive & Breeding Services

- Artificial Insemination (AI) kit
- Liquid Nitrogen (LN₂) container
- Semen straws & thawing equipment
- Pregnancy diagnosis tools
- Calving assistance equipment
- Uterine wash & obstetrical gloves

Minor Surgery Setup

- Sterilized surgical instruments
- Local anesthesia drugs
- Castration kit
- Abscess drainage kit
- Sutures & bandaging material
- Emergency kit for caesarean section
- Surgical kit for Rumentology

Artificial Insemination (AI) Kit



Liquid Nitrogen (LN₂) Container



Semen Straws & Thawing Equipment



Pregnancy Diagnosis Tools



Calving Assistance Equipment



Uterine Wash & Obstetrical Gloves



Uterine Wash & Obstetrical Gloves

Sterilized Surgical Instruments



Local Anesthesia Drugs



Castration Kit



Castration Kit



Abscess Drainage Kit



Sutures & Bandaging Material



Emergency Kit for Caesarean Section



Surgical Kit for Rumentology



Cold Chain & Storage

- Vaccine refrigerator / ice-lined fridge
- Cold boxes with ice packs
- Medicine storage racks
- Bio-medical waste containers
- Sharps disposal box

**Vaccine Refrigerator /
Ice-lined Fridge**



**Cold Boxes
with Ice Packs**



**Medicine
Storage Racks**



**Bio-medical Waste
Containers**



Sharps Disposal Box



**Vaccine Refrigerator
Insulated Cooler**

Hygiene & Biosecurity

- Autoclave / sterilizer
- Disinfectants (phenyl, iodine, chlorhexidine)
- Foot dip tray
- PPE: gloves, masks, aprons, gumboots
- Hand-wash station with water tank
- Full sleeve gloves for Placenta removal & AI

Autoclave / Sterilizer



**Disinfectants
(Phenyl, Iodine, Chlorhexidine)**



**Disinfectants
(Phenyl, Iodine, Chlorhexidine)**



Foot Dip Tray



**PPE: Gloves, Masks,
Aprons, Gumboots**



**Hand-wash Station
with Water Tank**



**PPE: Gloves, Masks,
Aprons, Gumboots**



**Full Sleeve Gloves for
Placenta Removal & AI**



Digital & Record Management

- Tablet / laptop
- Animal health record software
- AI & vaccination records
- Printer for prescriptions



**AI & Vaccination
Records**

Farmer Education & Outreach

Disease Prevention



- Vaccinations
- Deworming
- Hygiene & Sanitation
- Isolation of sick animals



Nutrition & Fodder Management

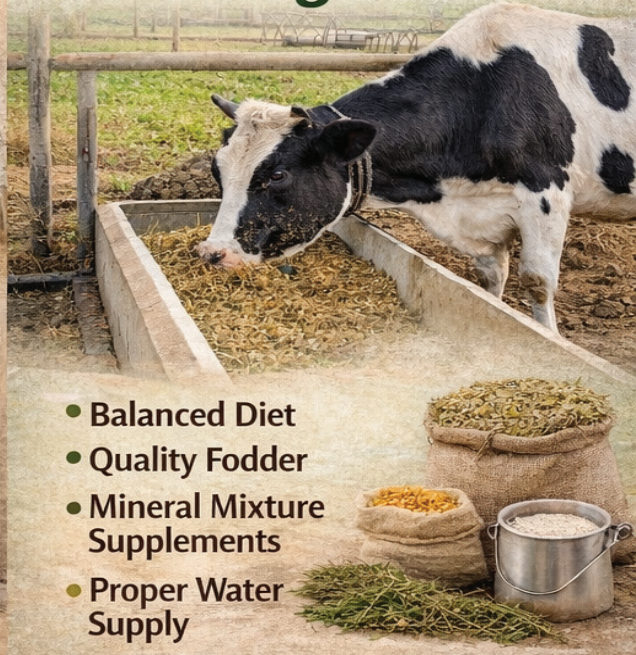

- Balanced Diet
- Quality Fodder
- Mineral Mixture Supplements
- Proper Water Supply

Clean Milk Production

- Milking Hygiene
- Regular Mastitis Testing
- Udder Health
- Proper Milk Storage

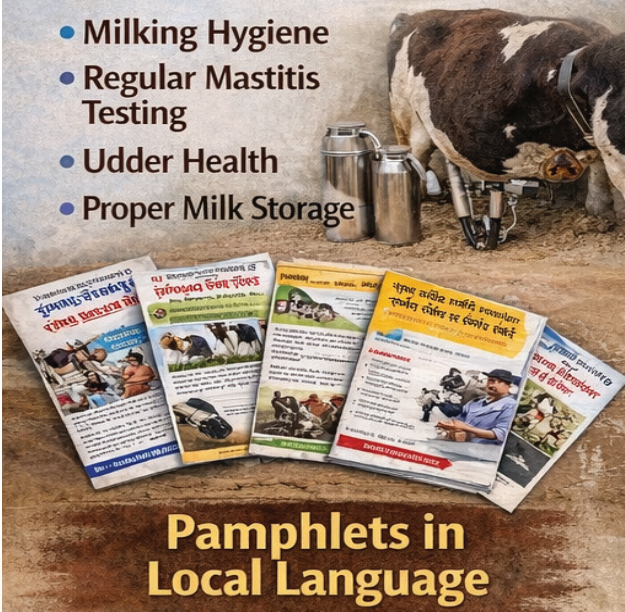

Pamphlets in Local Language



Audio-Visual Training Aids



Posters on:

- Disease prevention
- Nutrition & fodder management

- Clean milk production
- Pamphlets in local language
- Audio-visual training aids

Vehicle Choices



- ◀ **Platform: TATA Intra**
- Model: V20AC**
- Wheel Base: 2450 mm
- Ground Clearance: 175 mm
- Load Capacity: 1500 ton
- Tyre Size: 165R14



- Platform: TATA Yodha** ▶
- Model: Pickup1700**
- Wheel Base: 3300 mm
- Ground Clearance: 210 mm
- Load Capacity: 1700 ton
- Tyre Size: 215/75R16



- ◀ **Platform: Mahindra Veero**
- Model: V2A**
- Wheel Base: 2550 mm
- Ground Clearance: 216mm
- Load Capacity: 1400 ton
- Tyre Size: 195R15

- Platform: Mahindra Bolero** ▶
- Model: Pickup 4WD**
- Wheel Base: 3264 mm
- Ground Clearance: 200 mm
- Load Capacity: 1300 ton
- Tyre Size: 215/75R15





Contact us at
E-Mail: mukta@consultationguru.com
Mahima@consultationguru.com